

THE DORMAN



Base Price:
\$272,375 (2,179 SF)

**3 Bedroom 2 Bath
w/Bonus Room**

plus...Covered Back Porch

INCLUDED FEATURES:

ALL BRICK Exterior

2 zone HVAC
(comfort control system)

Open Floor Plan

Master Bath w/Double Vanity,
5 ft. Shower & Garden Tub

Granite Kitchen Counters

Hardwood Floors
(Main Living Areas)

Architectural Shingles

12 x12 Back Patio

Fully Sodded Yard
(with 3 zone irrigation)

Gas Heat/Water Heater

Craftsman Garage Door

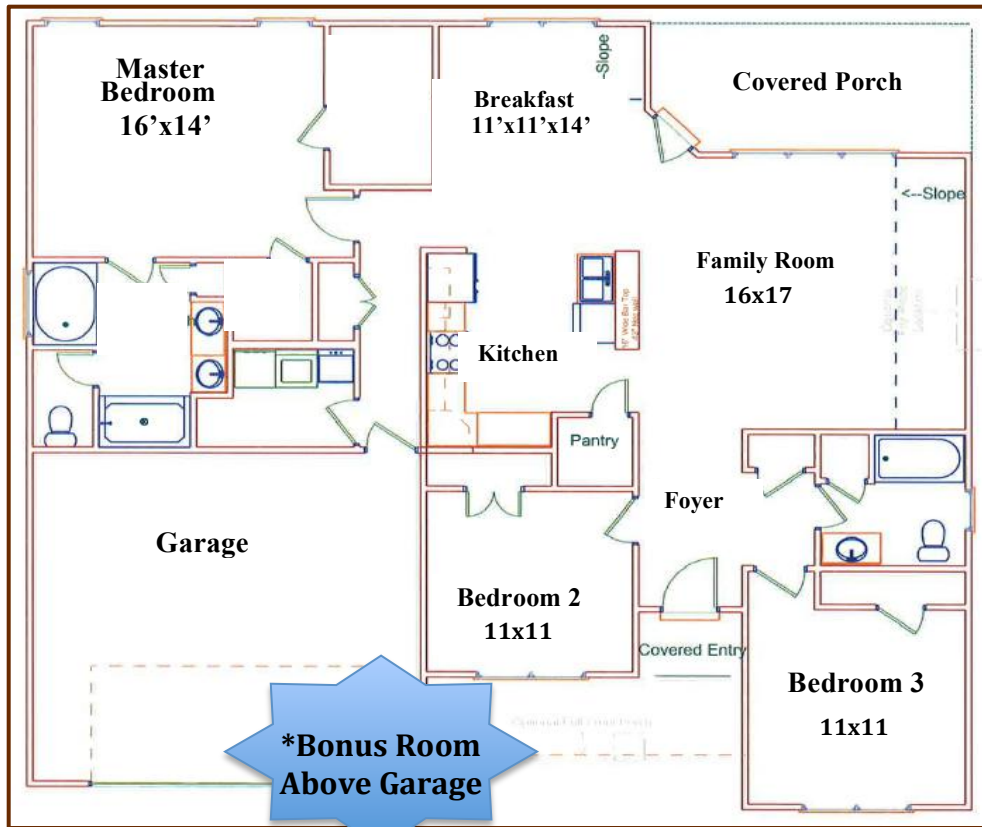

Marchant
REAL ESTATE

Marketed by
Shannon Cone
The CONE Team
864-908-6426

Built by:
McGee-Huntley
Construction

5/5/17 MM/SC



Continuing a policy of constant research and improvements. McGee-Huntley Construction reserves the right to change listed prices, plan, features, and specification without notice. All dimensions are approximate. All dimensions are approximate. All information is deemed to be accurate.